

How to login into the new VMware clients

1. Open the “VMware Horizon Client” software
2. Connect as always with the VMware Server.
3. Now the server will try to connect and open your browser with a login page for the Multi Factor Authentication (MFA). Please login here with your e-mail address and your password.
 - a. If you don't have the MFA configured yet, you can do it on the following webpage:
<https://mysignins.microsoft.com/security-info>

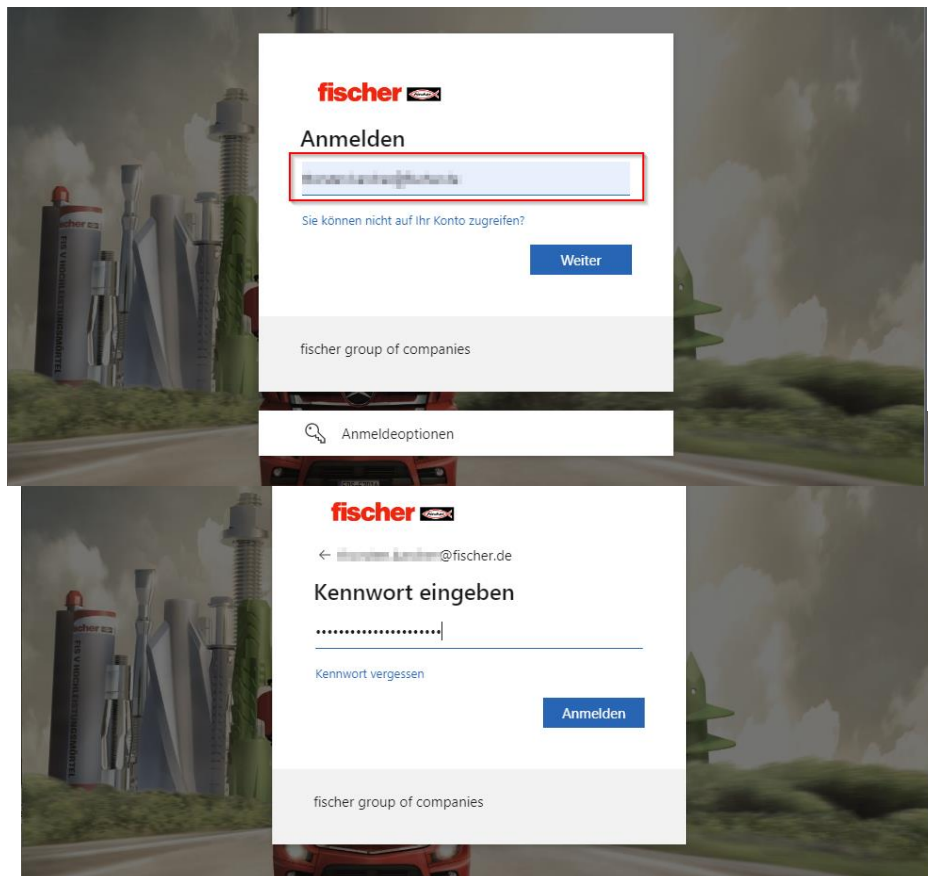

4. After the login, the VMware Client will start automatically. If not, click on the link in the following browser windows. You might be asked by your browser if it should open the VMware Client in the future automatically.

Launching Horizon client...

[Click here](#) if the client is not launched automatically.

5. Now the VMware Client should be back. Please login here with your e-mail address and your Windows password.

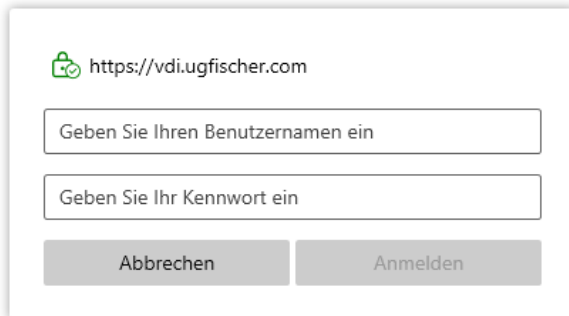

6. Now you should be able to open your virtual desktop.

Please note that in most cases your Desktop will be deleted after you logout (of after 8h disconnected). This helps to keep a good performance for all users. With your next login you will get a new created Desktop with your profile data restored.